

## Amazing front line apartment for sale in Playa d'en Bossa



**Price: 1.000.000 €**

### GENERAL INFORMATION

Category:	Apartments	Area:	Playa den Bossa
Location:	Ibiza Town	N. Bathroom:	2
N. Bedroom:	3	M <sup>2</sup> Inside:	m <sup>2</sup>
M <sup>2</sup> Property:			

### DESCRIPTION

We offer for sale a magnificent front floor apartment in the prestigious building of Playa d'en Bossa Royal Beach on the seafront. It is one of the most demanded of the island of Ibiza, both for location and for the quality of the apartments and the fantastic common areas, which have a swimming pool of a large and a sandy chill out area with Balinese hammocks and direct access to the sea.

This apartment is the ideal property for a second residence in the Mediterranean. This particular floor has 3 bedrooms and 2 bathrooms. Bathroom unbeatable finishes and is positioned in the front of the building so it has the best views. The flat includes a parking space. We offer for sale a magnificent front floor apartment in the prestigious building of Playa d'en Bossa Royal Beach on the seafront. It is one of the most demanded buildings on the island of Ibiza, both for its location and for the quality of the apartments and the fantastic common areas, which have a large swimming pool and a sandy chill-out area with Balinese hammocks and direct access to the sea.

This apartment is the ideal property for a second residence in the Mediterranean. This particular apartment has 3 bedrooms and 2 bathrooms, unbeatable finishes and is positioned at the front of the building so it has the best views. The flat includes a parking space.

















Plano no contractivo. Las medidas, colores, etc. no son definitivos, son orientativos. Las superficies son aproximadas y pueden sufrir variaciones por modificaciones técnicas, jurídicas o urbanísticas.

**GRUPORIGEL**



IbizaRoyalBeach  
Conjunto Residencial

SUPERFICIES PISO 318	
Superficie Usable vivienda	102.11 m <sup>2</sup>
Superficie Terraza	20.30 m <sup>2</sup>
Repercusión espacios comunes	13.55 m <sup>2</sup>
Superficie Total Construida	135.96 m <sup>2</sup>

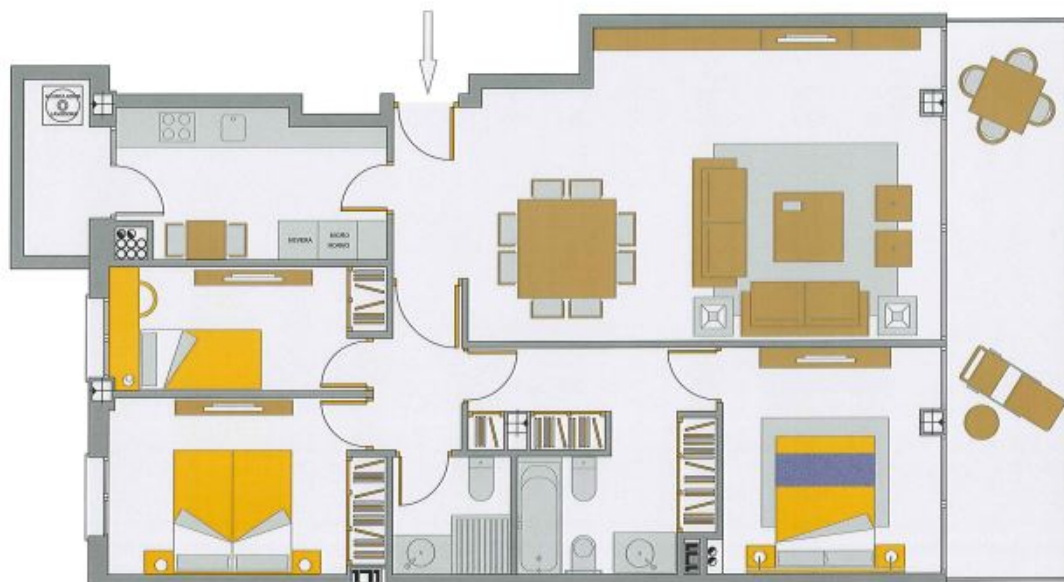

PLANTA 2 - PISO 318